

VICINITY MAP
NOT TO SCALE

MILLINOCKET MUNICIPAL AIRPORT MILLINOCKET, MAINE

MASTER PLAN UPDATE

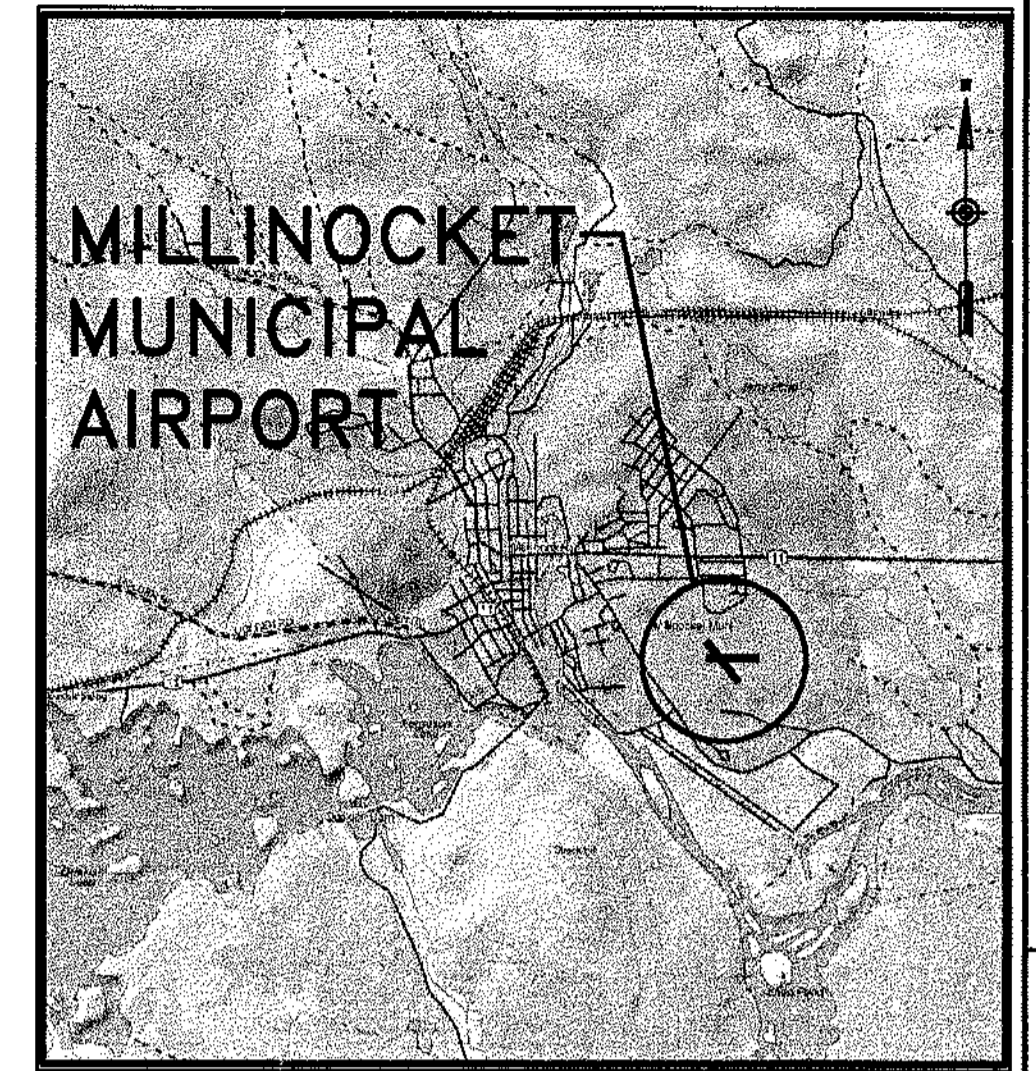

LOCATION MAP
NOT TO SCALE

MAINE DEPARTMENT OF TRANSPORTATION
STATE PROJECT NO. SAIP11.1026-02(13)
MILLINOCKET PROJECT NO. AIP3-23-2300-02

INDEX TO DRAWINGS

1. COVER/TITLE SHEET
2. ALP (EXISTING FACILITIES)
3. ALP (ULTIMATE FACILITIES)
4. ALP DATA SHEET
5. TERMINAL AREA PLAN
6. RUNWAY 11-29 PLAN AND PROFILE
7. RUNWAY 16-34 PLAN AND PROFILE
8. FAR PART 77 AIRSPACE SURFACES AND TERMINAL INSTRUMENT PROCEDURES SURFACES (TERPS)
9. LAND USE AND NOISE CONTOUR PLAN

MARCH, 2004

REVISIONS		STATE PROJECT NO.	CHKD. BY
REV. NO.	DATE	SAIP11.1026-02(13)	JRL
		MILLINOCKET PROJECT NO. <td> </td>	
		AIP3-23-2300-02 <td> </td>	
		DES. BY <td>DG</td>	DG
		DR. BY <td>RWH</td>	RWH
		SCALE: AS SHOWN <td>DATE: MARCH, 2004</td>	DATE: MARCH, 2004
PROJECT DESIGNER HFA Consulting Engineers Hc, Tanner & Associates, Inc. 120 W. 3 RD STREET - MANCHESTER, NH 03101-1227 Tel: (603) 688-5555 Fax: (603) 688-4168 WEB PAGE: www.hta-nh.com		MILLINOCKET MUNICIPAL AIRPORT AIRPORT MASTER PLAN UPDATE COVER/TITLE SHEET	
HTA PROJ. No.: 302902.02		DRAWING NO.	
MILCV01.dwg		1	
SHEET 1 OF 9		REV	

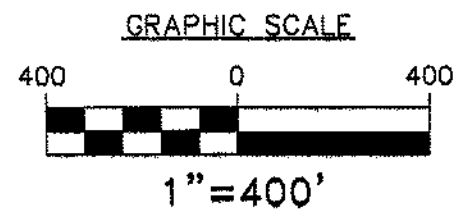
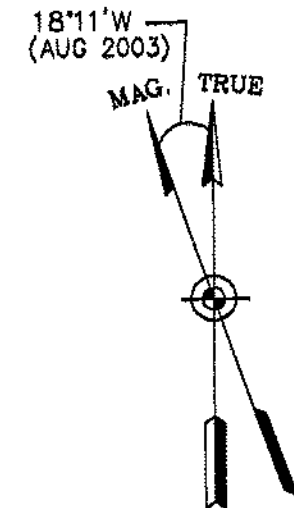
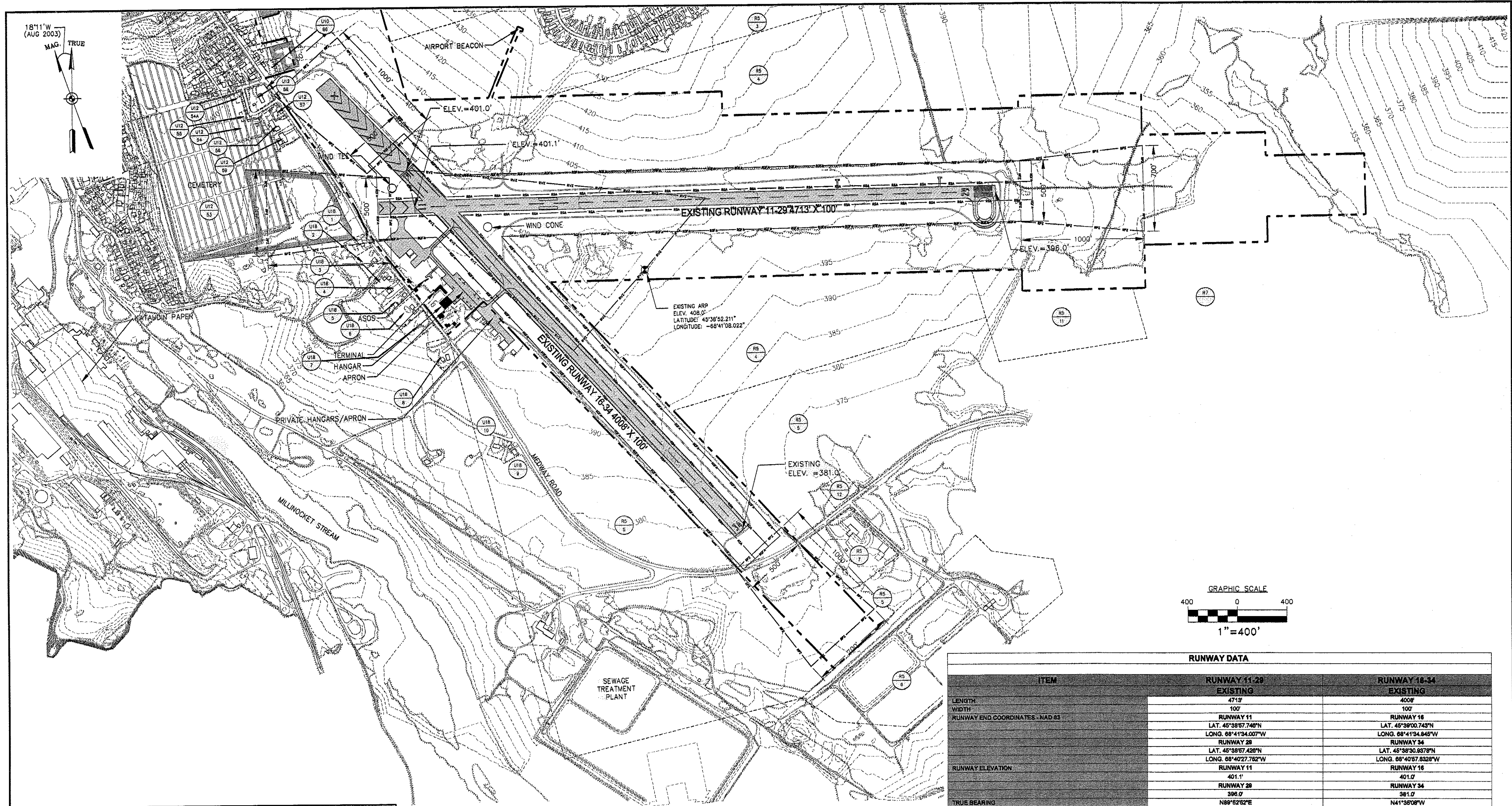

LEGEND	
SYMBOL	DESCRIPTION
	ROAD PAVEMENT EDGE
	EXISTING RUNWAY PAVEMENT EDGE
	PROPOSED RUNWAY PAVEMENT EDGE
	RUNWAY CENTERLINE
	EXISTING PAVEMENT
	EXISTING TREE LINE
	EXISTING CONTOUR (TYP)
	BUILDINGS ON AIRPORT PROPERTY
	EXISTING BUILDING
	AIRPORT PROPERTY LINE
	ABUTTING PROPERTY LINES
	EXISTING AVIATION EASEMENT AREA
SYMBOL	DESCRIPTION
	MAP & LOT NUMBERS FOR ABUTTING PROPERTIES TO THE AIRPORT. NOTE: ALL ABUTTER INFO IS NOT COMPLETELY SHOWN. SEE DATA SHT. FOR COMPLETE LIST.
	EXISTING/ULTIMATE PART 77/TERPS PENETRATIONS
	SEGMENTED CIRCLE/LIGHTED WINDSOCK (SEE CALLOUT)
	AIRPORT BEACON/UNLIGHTED WINDSOCK (SEE CALLOUT)
	EXISTING TIE DOWN
	RUNWAY PROTECTION ZONE
	RUNWAY SAFETY AREA
	RUNWAY OBJECT FREE AREA
	TAXIWAY SAFETY AREA
	TAXIWAY OBJECT FREE AREA
	RUNWAY VISIBILITY ZONE

BASIC AIRPORT DATA	
ITEM	EXISTING
AIRPORT ELEVATION (U.S.G.S. - M.S.L.)	408.0'
AIRPORT REFERENCE POINT (ARP)	LAT. 45°38'52.211"N LONG. 68°41'08.022"W
MEAN MAX TEMPERATURE HOTTEST MONTH	80°F
NAVIGATIONAL AIDS	RUNWAY 28: GPS/NDB & LOC
DISTANCE FROM TOWN OF MILLINOCKET	1 MI. SE
LAND OWNED (ACRES)/AIRPORT AREA FEE	322.00
AIRPORT AREA EASEMENTS (ACRES)	NONE
OWNER	TOWN OF MILLINOCKET, MAINE
OPERATIONAL ROLE (NPIAS)	GA
MAG. DECLINATION AUG 22, 2003	18°-11'W
AIRPORT REFERENCE CODE/AIRPORT DESIGN CODE	B-II

ITEM	RUNWAY 11-29	RUNWAY 16-34
	EXISTING	EXISTING
LENGTH	4713'	4008'
WIDTH	100'	100'
RUNWAY END COORDINATES - NAD 83	RUNWAY 11 LAT. 45°38'57.746"N LONG. 68°41'34.007"W	RUNWAY 16 LAT. 45°39'00.745"N LONG. 68°41'54.848"W
RUNWAY ELEVATION	RUNWAY 11 401.1' RUNWAY 28 396.0'	RUNWAY 16 401.0' RUNWAY 34 381.0'
TRUE BEARING	N88°52'52"E	N41°38'08"W
PAVEMENT STRENGTH	30,000 LBS. SINGLE WHEEL 44,000 LBS. DUAL WHEEL	30,000 LBS. SINGLE WHEEL 44,000 LBS. DUAL WHEEL
SURFACE MATERIAL	ASPHALT	ASPHALT
EFFECTIVE GRADIENT (%)	RUNWAY 11: (-0.13%) RUNWAY 28: (+0.13%)	RUNWAY 16: (-0.40%) RUNWAY 34: (+0.40%)
CLASSIFICATION/APPROACH CATEGORY	RUNWAY 11: VISUAL (20:1) RUNWAY 28: NON-PRECISION (34:1)	RUNWAY 16: VISUAL (20:1) RUNWAY 34: VISUAL (20:1)
APPROACH MINIMUMS (CEILING/MSL)	RUNWAY 11: 1,000' & VIS. 3 MILE RUNWAY 28: 600' & VIS. 1 MILE	RUNWAY 16: 1,000' & 3 MILE RUNWAY 34: 1,000' & 3 MILE
VISUAL/APPROACH AIDS	RUNWAY 11: WINDSOCK, REIL, LIGHTED WIND TEE RUNWAY 28: VASI, WINDSOCK, LIGHTED WIND TEE	RUNWAY 16: WINDSOCK, LIGHTED WIND TEE RUNWAY 34: WINDSOCK, LIGHTED WIND TEE
NAVIGATIONAL AIDS	RUNWAY 11: NONE RUNWAY 28: LOC/NDB OR GPS	RUNWAY 16: NONE RUNWAY 34: NONE
RUNWAY LIGHTING	MIRLS	NONE
RUNWAY MARKING	RUNWAY 11: BASIC RUNWAY 28: NON-PRECISION	RUNWAY 16: BASIC RUNWAY 34: BASIC
RPZ (Length/Width/Width)	RW-11: 1000', 500', 700'	RW-16: 1000', 500', 700'
DESIGNATED INSTRUMENT RUNWAY	RUNWAY 28: GPS OR NDB/LOC	NONE
CRITICAL AIRCRAFT (WING SPAN)	40.7'	40.7'
CRITICAL AIRCRAFT APPROACH SPEED	100 Knots	87 Knots
CRITICAL AIRCRAFT MTOW	7000 lbs	3,000 lbs
AIRPLANE DESIGN GROUP	II	I
AIRCRAFT APPROACH CATEGORY	B	A
PARALLEL TAXIWAY	NONE	NONE
TAXIWAY LIGHTING	NONE	NONE

PROJECT DESIGNER Hoyle, Tanner & Associates, Inc. 150 DOW STREET - MANCHESTER, NH 03101 - 1227 Tel: (603) 669-5555 Fax: (603) 669-4168 WEB PAGE: www.hta-nh.com		STATE PROJECT NO. SAIP11.1026-02(13)	MILLINOCKET PROJECT NO. AIP3-23-2300-02
PROJECT NO. SAIP11.1026-02(13)	MILLINOCKET PROJECT NO. AIP3-23-2300-02	REVISIONS BY DATE	DES. BY DG
DR. BY DDS	CHKD. BY JRL	SCALE: AS SHOWN DATE: MARCH, 2004	SHEET 2 OF 9
MILLINOCKET MUNICIPAL AIRPORT AIRPORT MASTER PLAN UPDATE		AIRPORT LAYOUT PLAN (EXISTING FACILITIES)	
HTA PROJ. No.: 302902.02 MILEALP.DWG		DRAWING NO. 2	

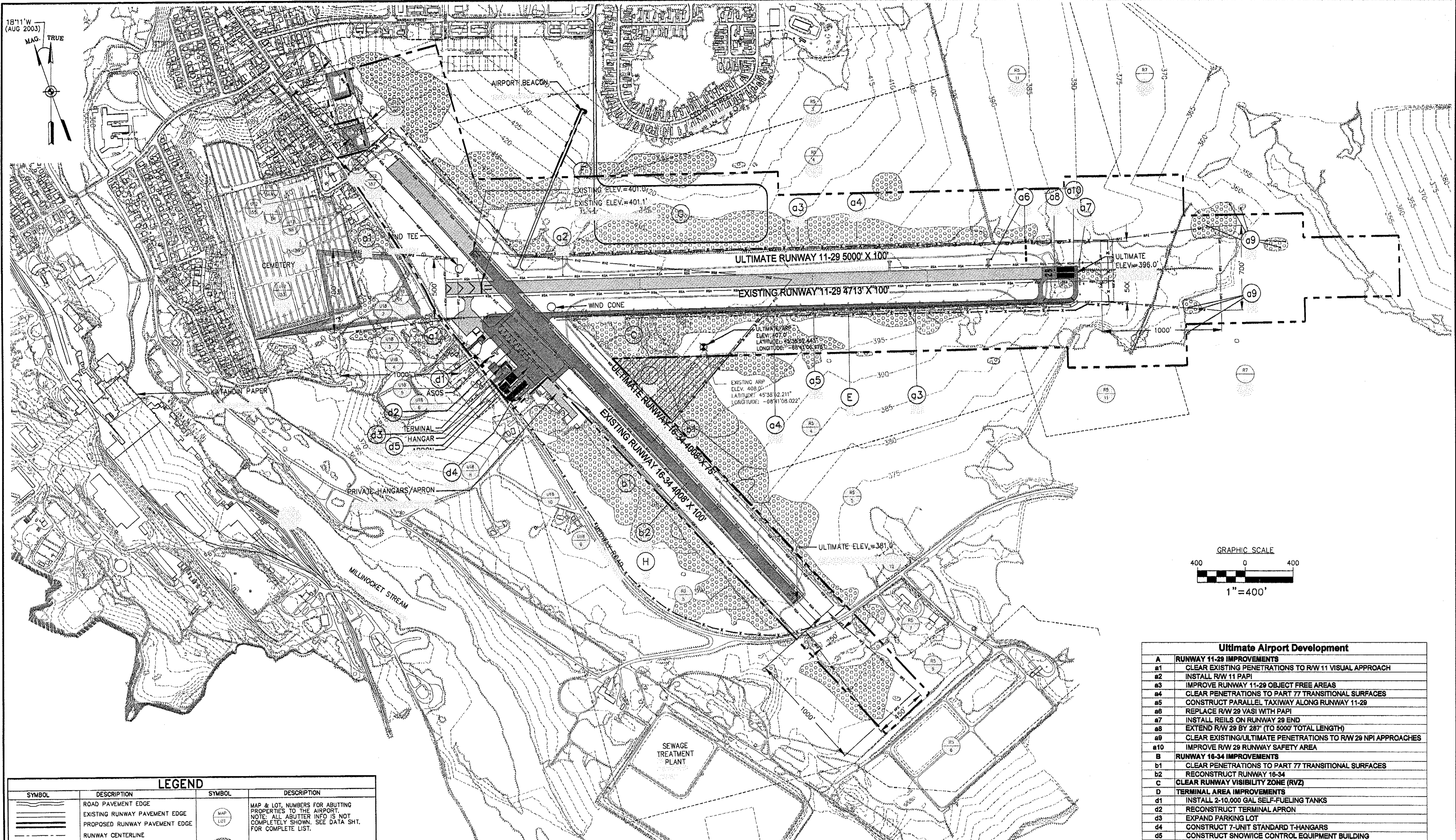

REVISIONS	
REV. NO.	DATE

STATE PROJECT NO. SAIP11.1026-02(13)
 MILLINOCKET PROJECT NO. AIP3-23-2300-02

HTA
 Consulting Engineers

PROJECT DESIGNER
Hoyle, Tanner & Associates, Inc.
 150 DOW STREET - MANCHESTER, NH 03101 - 1227
 Tel: (603) 669-5555 Fax: (603) 669-4168 WEB PAGE: www.hta-nh.com

SCALE: AS SHOWN DATE: MARCH, 2004

DR. BY: RWH
 DES. BY: DG
 CHKD. BY: JRL

LEGEND	
SYMBOL	DESCRIPTION
	ROAD PAVEMENT EDGE
	EXISTING RUNWAY PAVEMENT EDGE
	PROPOSED RUNWAY PAVEMENT EDGE
	RUNWAY CENTERLINE
	EXISTING PAVEMENT
	ULTIMATE PAVEMENT
	EXISTING TREE LINE
	EXISTING CONTOUR (TYP)
	PROPOSED BUILDINGS
	BUILDING TO BE REMOVED
	EXISTING BUILDING
	AIRPORT PROPERTY LINE
	ABUTTING PROPERTY LINES
	EXISTING AVIATION EASEMENT AREA
	MAP & LOT NUMBERS FOR ABUTTING PROPERTIES TO THE AIRPORT. NOTE: ALL ABUTTER INFO IS NOT COMPLETELY SHOWN. SEE DATA SHT. FOR COMPLETE LIST.
	EXISTING/ULTIMATE PART 77/TERPS PENETRATIONS
	SEGMENTED CIRCLE/LIGHTED WINDSOCK
	AIRPORT BEACON/UNLIGHTED WINDSOCK
	EXISTING TIE DOWN
	RUNWAY PROTECTION ZONE
	RUNWAY SAFETY AREA
	RUNWAY OBJECT FREE AREA
	TAXIWAY SAFETY AREA
	TAXIWAY OBJECT FREE AREA
	ULTIMATE RUNWAY VISIBILITY ZONE
	EXISTING RUNWAY VISIBILITY ZONE

BASIC AIRPORT DATA		
ITEM	EXISTING	ULTIMATE
AIRPORT ELEVATION (U.S.G.S. - M.S.L.)	408.0'	SAME
AIRPORT REFERENCE POINT (ARP)	LAT. 45°38'52.211"N LONG. 68°41'08.022"W	LAT. 45°38'52.443"N LONG. 68°41'08.970"W
MEAN MAX TEMPERATURE HOTTEST MONTH	80°F	SAME
NAVIGATIONAL AIDS	RUNWAY 28: GPS/NDB & LOC	RUNWAY 11: GPS & PAPI RUNWAY 28: GPS/NDB & LOC & PAPI
DISTANCE FROM TOWN OF MILLINOCKET	1 MI. SE	SAME
LAND OWNED (ACRES)/AIRPORT AREA FEE	322.0	SAME
AIRPORT AREA EASEMENTS (ACRES)	NONE	SAME
OWNER	TOWN OF MILLINOCKET, MAINE	SAME
OPERATIONAL ROLE (NPIAS)	GA	SAME
MAG. DECLINATION 1994	18°11'W	4° PER YEAR DEGREE OF CHANGE
AIRPORT REFERENCE CODE/AIRPORT DESIGN CODE	B-II	RW-11-29-B-II RW-16-34-B-I

NON CONFORMING CONDITIONS	
	DESCRIPTION

Ultimate Airport Development	
A	RUNWAY 11-29 IMPROVEMENTS
a1	CLEAR EXISTING PENETRATIONS TO R/W 11 VISUAL APPROACH
a2	INSTALL R/W 11 PAPI
a3	IMPROVE RUNWAY 11-29 OBJECT FREE AREAS
a4	CLEAR PENETRATIONS TO PART 77 TRANSITIONAL SURFACES
a5	CONSTRUCT PARALLEL TAXIWAY ALONG RUNWAY 11-29
a6	REPLACE R/W 29 VASI WITH PAPI
a7	INSTALL REELS ON RUNWAY 29 END
a8	EXTEND R/W 29 BY 287' (TO 6000' TOTAL LENGTH)
a9	CLEAR EXISTING/ULTIMATE PENETRATIONS TO R/W 29 NPI APPROACHES
a10	IMPROVE R/W 29 RUNWAY SAFETY AREA
B	RUNWAY 16-34 IMPROVEMENTS
b1	CLEAR PENETRATIONS TO PART 77 TRANSITIONAL SURFACES
b2	RECONSTRUCT RUNWAY 16-34
C	CLEAR RUNWAY VISIBILITY ZONE (RVZ)
D	TERMINAL AREA IMPROVEMENTS
d1	INSTALL 2-10,000 GAL SELF-FUELING TANKS
d2	RECONSTRUCT TERMINAL APRON
d3	EXPAND PARKING LOT
d4	CONSTRUCT 7-UNIT STANDARD T-HANGARS
d5	CONSTRUCT SNOW/ICE CONTROL EQUIPMENT BUILDING
E	INSTALL WILDLIFE/SECURITY FENCE
F	IMPROVE ACCESS ROAD TO ROTATING BEACON
G	INDUSTRIAL PARK (NON-AVIATION ACTIVITIES)
H	INDUSTRIAL PARK (AVIATION ACTIVITIES)
I	ACQUIRE PROPERTY/CLEAR RUNWAY VISIBILITY ZONE (RVZ)

FEDERAL AVIATION ADMINISTRATION
 NEW ENGLAND REGION
 AIRPORT DIVISION

MAINE DEPARTMENT OF TRANSPORTATION
 OFFICE OF PASSENGER TRANSPORTATION

TOWN OF MILLINOCKET

APPROVED: *[Signature]* DATE: 8/2/2007
 2006-A3E-19-NH

APPROVED: *[Signature]* DATE: 9-22-04

APPROVED: *[Signature]* DATE: 6/21/04

HTA PROJ. No.: 302902.02
 MILPALP.DWG

DRAWING NO. **3**

SHEET 3 OF 9

MILLINOCKET MUNICIPAL AIRPORT
 AIRPORT MASTER PLAN UPDATE

**AIRPORT LAYOUT PLAN
 (ULTIMATE FACILITIES)**

RUNWAY DATA				
ITEM	RUNWAY 11-29		RUNWAY 16-34	
	EXISTING	ULTIMATE	EXISTING	ULTIMATE
PHYSICAL LENGTH	4713'	5000'	4008'	SAME
WIDTH	100'	SAME	100'	75'
RUNWAY END COORDINATES - NAD 83	RUNWAY 11 LAT. 45°38'57.746"N LONG. 68°41'34.007"W	RUNWAY 11 SAME	RUNWAY 16 LAT. 45°39'00.743"N LONG. 68°41'34.845"W	RUNWAY 16 SAME
RUNWAY ELEVATION	RUNWAY 29 LAT. 45°38'57.426"N LONG. 68°40'27.782"W	RUNWAY 29 LAT. 45°38'57.449"N LONG. 68°40'23.566"W	RUNWAY 34 LAT. 45°38'30.9378"N LONG. 68°40'57.8328"W	RUNWAY 34 SAME
TRUE BEARING	396.0'	SAME	391.0'	SAME
PAVEMENT STRENGTH	30,000 LBS. SINGLE WHEEL	SAME	12,500 LBS. SINGLE WHEEL	SAME
SURFACE MATERIAL	ASPHALT	SAME	ASPHALT	SAME
EFFECTIVE GRADIENT (%)	RUNWAY 11: (-0.13%) RUNWAY 29: (+0.13%)	SAME	RUNWAY 16: (-0.40%) RUNWAY 34: (+0.40%)	SAME
CLASSIFICATION/APPROACH CATEGORY	RUNWAY 11: VISUAL RUNWAY 29: NON-PRECISION	RUNWAY 11: NON-PRECISION	RUNWAY 16: VISUAL RUNWAY 34: VISUAL	SAME
APPROACH MINIMUMS (CEILING/VISIBILITY)	RUNWAY 11: 1000' & VIS. 3 MILE RUNWAY 29: 600' & VIS. 1 MILE	SAME	RUNWAY 16: 1000' & VIS. 3 MILE RUNWAY 34: 1000' & VIS. 3 MILE	SAME
VISUAL/APPROACH AIDS	RUNWAY 11: WINDSOCK, REIL, LIGHTED WIND TEE RUNWAY 29: VASI, WINDSOCK, LIGHTED WIND TEE	RUNWAY 11: WINDSOCK, REIL, LIGHTED WIND TEE and PAPI PAPI, WINDSOCK, LIGHTED WIND TEE, REILS	RUNWAY 16: WINDSOCK, LIGHTED WIND TEE RUNWAY 34: WINDSOCK, LIGHTED WIND TEE	SAME
NAVIGATIONAL AIDS	RUNWAY 11: NONE RUNWAY 29: LOC/NDB OR GPS	SAME	RUNWAY 16: NONE RUNWAY 34: NONE	SAME
RUNWAY LIGHTING	MIRLS	SAME	NONE	SAME
RUNWAY MARKING	RUNWAY 11: BASIC RUNWAY 29: NON-PRECISION	RUNWAY 11 NON-PRECISION	RUNWAY 16: BASIC RUNWAY 34: BASIC	SAME
DESIGNATED INSTRUMENT RUNWAY	RUNWAY 29: GPS OR NDB/LOC	SAME	NONE	SAME
CRITICAL AIRCRAFT (WING SPAN)	40.7'	SAME	N/A	SAME
CRITICAL AIRCRAFT APPROACH SPEED	100 Knots	SAME	N/A	SAME
CRITICAL AIRCRAFT MTOW	7000 lbs	SAME	N/A	SAME
AIRPLANE DESIGN GROUP	II	SAME	I	SAME
AIRCRAFT APPROACH CATEGORY	B	SAME	B	SAME
PARALLEL TAXIWAY	NONE	5,000' X 36'	NONE	NONE
TAXIWAY LIGHTING	NONE	MITLS	NONE	NONE

NOTES:

AIRPORT ABUTTERS			
MAP	OWNER	BOOK	PAGE
RS-3	KATAHDIN PAPER		
RS-4	KATAHDIN PAPER		
RS-4-0N6	WEST BRANCH AVIATION		
RS-5	KATAHDIN PAPER		
RS-6	TOWN OF MILLINOCKET WWTP		
RS-7	TOWN OF MILLINOCKET TRANSFER SITE		
RS-11	ELKS LODGE	5454	61
RS-12	MERRY, REBECCA	7898	186
U10-1	DAIGLE, LOIS	2710	331
U10-1A	GUY, DAVID	2428	34
U10-2	CORMIER, EDRIK	3147	256
U10-4	RAY, DOUGLAS	7311	319
U10-5	HEBERT, MICHAEL	6806	316
U10-6	DARLING, RONALD	3194	276
U10-8	JOHNSTON, BRIAN	8270	99
U10-9	MCAVOY, WILLIAM	1808	306
U10-10	BOUTAUGH, DOUGLAS	3283	281
U10-11	ELLIOTT, DONALD	1400	215
U10-12	PATCHELL, NORMAN	2818	215
U10-13	MARTIN, RICHARD	8337	145
U10-15	BAKER, DAVID	7898	24
U10-16	AUSTIN, VALICE	7640	20
U10-16A	TAPLEY, GEORGE	2578	326
U10-17	BERNIER, RICHARD	2480	213
U10-18	NYMAN, JAMES	4801	73
U10-19	FLOURDE, JOHN	4410	105
U10-20	BLOUCHARD, R ET AL (ERIC)	1906	389
U10-21	BURRELL, ROSCOE	2208	516
U10-22	BELL, ELMER	3604	23
U10-23	MOIR, WANETA	5176	324
U10-45	MANIZO, STEVEN	4478	338
U10-77	TAPLEY, EDWARD	5755	104
U10-78	NADEAU, ARTHUR	3106	171
U10-80	MCEWEN, JOY	7674	18
U10-82	ROBINSON, WILMOT	3484	72
U10-83	BINDER, GARY	5858	102
U10-84	TOWN-MORGAN LAND ONLY		
U10-96	BABBIDGE, JEAN	4511	283
U12-63	CEMETARY		
U12-64A	DAVIS, KEVIN	7373	79
U12-66	CYR, PATRICK	7184	332
U12-67	JANDREAU, AARON	7267	282
U12-68	MCNALLY, SANDRA	6115	349
U12-69	JANDREAU, BRUCE	3051	292
U18-1	BROWN, HELEN	3039	201
U18-2	BOYER, FREDERICK	6012	204

PART 77 APPROACH SLOPE DATA			
ULTIMATE	RUNWAY	APPROACH CATEGORY	APPROACH SLOPE
	11	NON-PRECISION	34:1
	29	NON-PRECISION	34:1
	16	VISUAL	20:1
	34	VISUAL	20:1
EXISTING	11	VISUAL	20:1
EXISTING	29	NON-PRECISION	34:1
EXISTING	16	VISUAL	20:1
EXISTING	34	VISUAL	20:1

RUNWAY PROTECTION ZONE DATA					
	RUNWAY	APPROACH CATEGORY	"L"	"A"	"B"
ULTIMATE	11	NON-PRECISION	SAME	SAME	SAME
ULTIMATE	29	SAME	SAME	SAME	SAME
ULTIMATE	16	SAME	SAME	250	400
ULTIMATE	34	SAME	SAME	250	400
EXISTING	11	VISUAL	1,000	500	700
EXISTING	29	NON-PRECISION	1,000	500	700
EXISTING	16	VISUAL	1,000	500	700
EXISTING	34	VISUAL	1,000	500	700

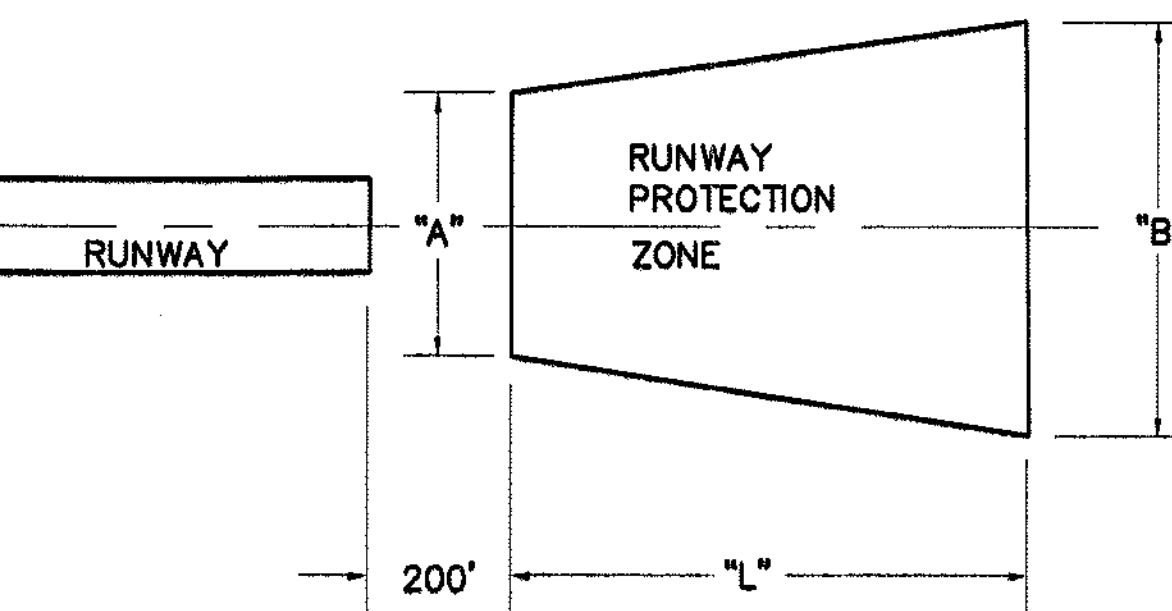

DESIGN ELEMENT	RUNWAY 11-29 (ARC B-II)		RUNWAY 16-34 (ARC B-I)	
	EXISTING	ULTIMATE	EXISTING	ULTIMATE
RUNWAY LENGTH	4,713	5,000	4,008	SAME
RUNWAY WIDTH	100	SAME	100	75
RUNWAY SAFETY AREA (RSA) WIDTH	150	SAME	120	SAME
LENGTH BEYOND RUNWAY END	300	SAME	240	SAME
RUNWAY OBSTACLE FREE ZONE (ROFZ) WIDTH	400	SAME	400	SAME
LENGTH BEYOND RUNWAY END	200	SAME	200	SAME
RUNWAY OBJECT FREE AREA (ROFA) WIDTH	500	SAME	400	SAME
LENGTH BEYOND RUNWAY END	300	SAME	240	SAME
TAXIWAY/TAXILANE WIDTH	NONE	35	TAXIWAY B = 30 TAXIWAY C = 40	35
TAXIWAY SAFETY AREA (TSA) WIDTH	N/A	79	49	SAME
TAXIWAY OBJECT FREE AREA (TOFA) WIDTH	N/A	131	88	SAME
TAXILANE OBJECT FREE AREA WIDTH	N/A	115	79	SAME
RUNWAY SEPARATION STANDARDS				
RUNWAY CENTERLINE TO TAXIWAY/TAXILANE CENTERLINE	N/A	240	N/A	N/A
RUNWAY CENTERLINE TO AIRCRAFT PARKING AREA	250	SAME	200	SAME
TAXIWAY/TAXILANE SEPARATION STANDARDS				
TAXIWAY CENTERLINE TO PARALLEL TAXIWAY/TAXILANE CENTERLINE	N/A	N/A	N/A	N/A
TAXIWAY CENTERLINE TO A FIXED OR MOVABLE OBJECT	65.5	SAME	44.5	SAME
TAXILANE CENTERLINE TO PARALLEL TAXILANE CENTERLINE	97	SAME	84	SAME
TAXILANE CENTERLINE TO A FIXED OR MOVABLE OBJECT	57.5	SAME	39.5	SAME

NOTES:
1 - SEE FURTHER DISCUSSION IN THE MASTER PLAN UPDATE REPORT

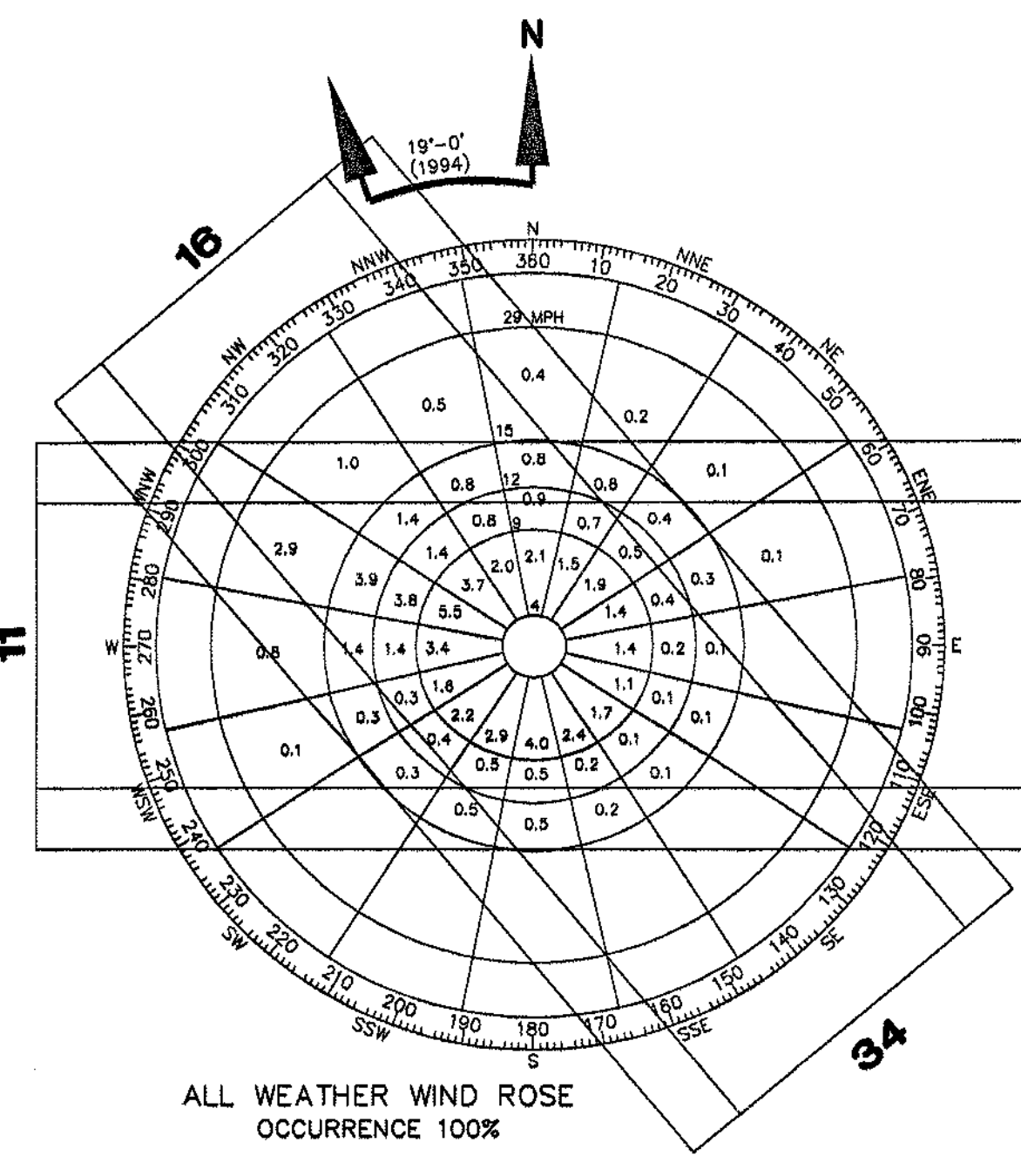

RUNWAY	12 M.P.H.	15 M.P.H.
16	20.5	21.4
34	44.0	46.8
11	19.1	20.5
29	44.7	47.4
CALMS	31.2	31.2
16-34	95.7	99.4
11-29	95.0	99.1
COMBINED	98.8	99.9

SOURCE:
STATION 14610 - MILLINOCKET MAINE - 43611 OBSERVATIONS JAN. 1960 THROUGH DEC. 1964
△ = CALMS, 31.2%

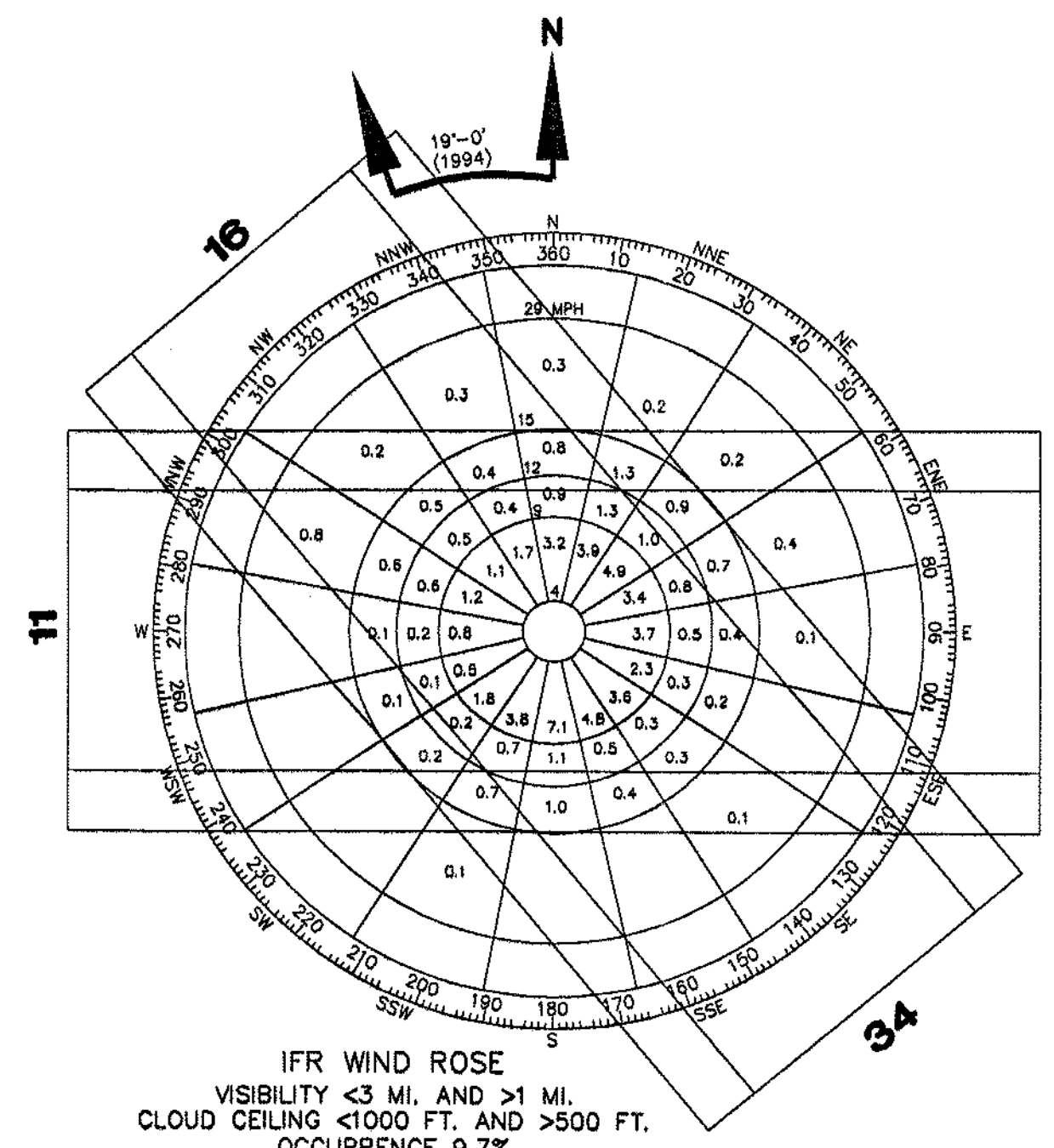

RUNWAY	12 M.P.H.	15 M.P.H.
16	38.9	40.5
34	25.4	27.3
11	41.7	43.8
29	22.0	23.9

SOURCE:
STATION 14610 - MILLINOCKET MAINE - 43611 OBSERVATIONS JAN. 1960 THROUGH DEC. 1964
△ = CALMS, 31.5%

REVISIONS BY DATE

STATE PROJECT NO. SA111.1026-02(13)

MILLINOCKET PROJECT NO. AIP3-23-2300-02

PROJECT DESIGNER: **HTA Hoyle, Tanner & Associates, Inc.**

150 DOW STREET - MANCHESTER, NH 03101 - 1227
Tel: (603) 689-5555 Fax: (603) 689-4188 WEB PAGE: www.hta-nh.com

SCALE: AS SHOWN DATE: MARCH, 2004

MILLINOCKET MUNICIPAL AIRPORT AIRPORT MASTER PLAN UPDATE

ALP DATA SHEET

HTA PROJ. No.: 302902.02

MIDSHIT.dwg

DRAWING NO. **4**

SHEET 4 OF 9

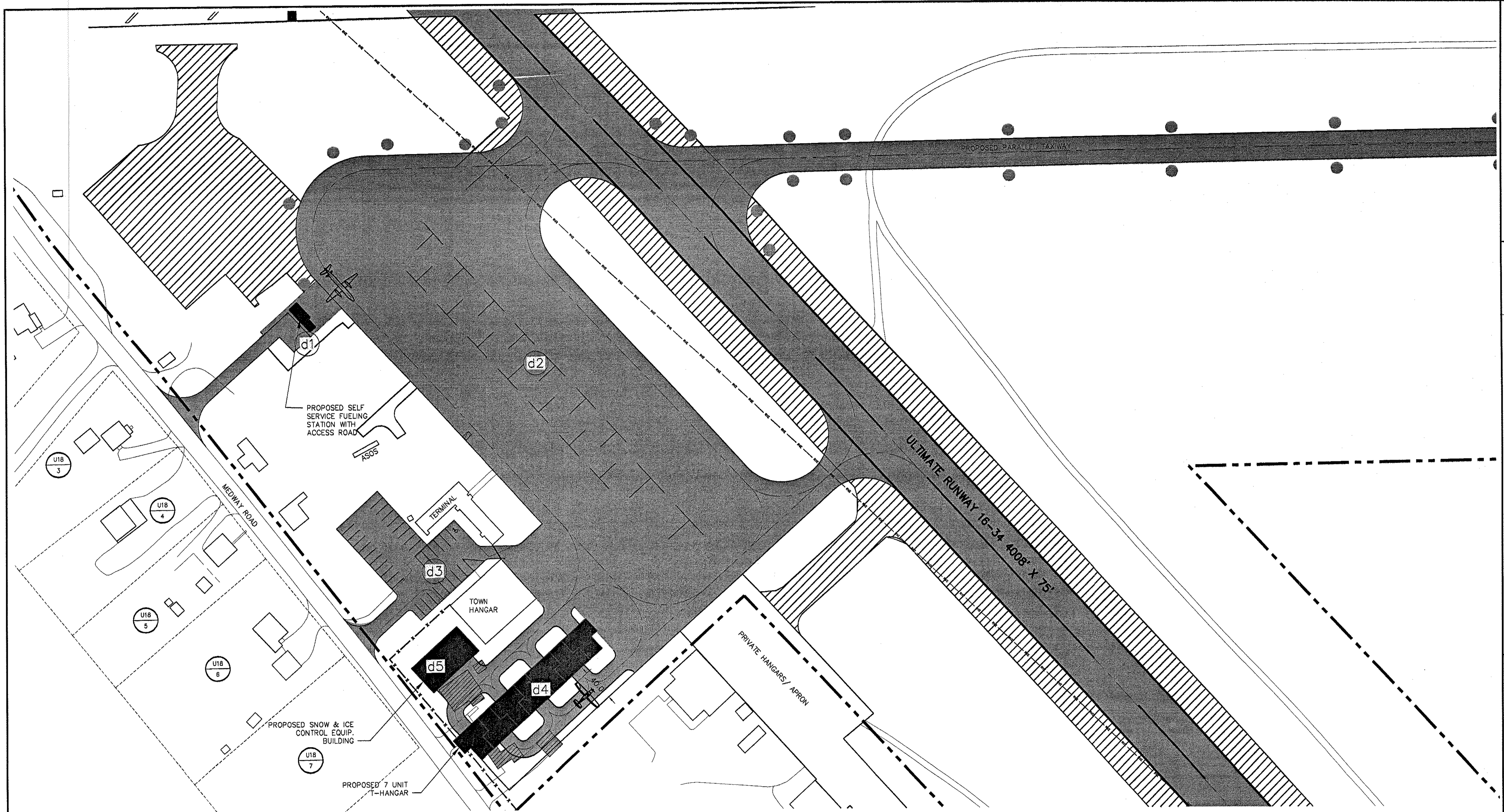

LEGEND

SYMBOL	DESCRIPTION	SYMBOL	DESCRIPTION
	ROAD PAVEMENT EDGE		MAP & LOT NUMBERS FOR ABUTTING PROPERTIES TO THE AIRPORT. NOTE: ALL ABUTTING INFO IS NOT COMPLETELY SHOWN. SEE DATA SHT. FOR COMPLETE LIST.
	EXISTING PAVEMENT EDGE		SEGMENTED CIRCLE/LIGHTED WINDSOCK
	PROPOSED PAVEMENT EDGE		AIRPORT BEACON/UNLIGHTED WINDSOCK
	RUNWAY, TAXIWAY & TAXILANE CENTERLINE		EXISTING TURF TIE DOWN
	PROPOSED PAVEMENT		RUNWAY PROTECTION ZONE
	EXISTING PAVEMENT		RUNWAY SAFETY AREA
	PAVEMENT TO BE REMOVED		RUNWAY OBJECT FREE AREA
	EXISTING TREE LINE		TAXIWAY SAFETY AREA
	EXISTING CONTOUR (TYP)		TAXIWAY OBJECT FREE AREA
	PROPOSED BUILDINGS		RUNWAY VISIBILITY ZONE
	BUILDING TO BE REMOVED		
	EXISTING BUILDING		
	AIRPORT PROPERTY LINE		
	ABUTTING PROPERTY LINES		
	EXISTING AVIGATION EASEMENT AREA		

MILLINOCKET MUNICIPAL AIRPORT
AIRPORT MASTER PLAN UPDATE

PROJECT DESIGNER
Hoyle, Tanner & Associates, Inc.
150 DOW STREET - MANCHESTER, NH 03101 - 1227
Tel: (603) 669-5555 Fax: (603) 669-4168 WEB PAGE: www.hta-nh.com

HTA
Consulting Engineers

STATE PROJECT NO. SAIP11-1026-02(13)
MILLINOCKET PROJECT NO. AIP3-23-2300-02

REVISIONS

REV. NO.	DATE	BY	DESCRIPTION

DR. BY: DDS
DES. BY: DC
DATE: MARCH, 2004
SCALE: AS SHOWN

CHKD. BY: JRL

TERMINAL PLAN

MILTRML.DWG

HTA PROJ. No.: 302902.02

DRAWING NO. **5**

SHEET 5 OF 9

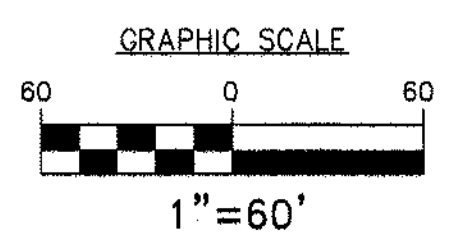

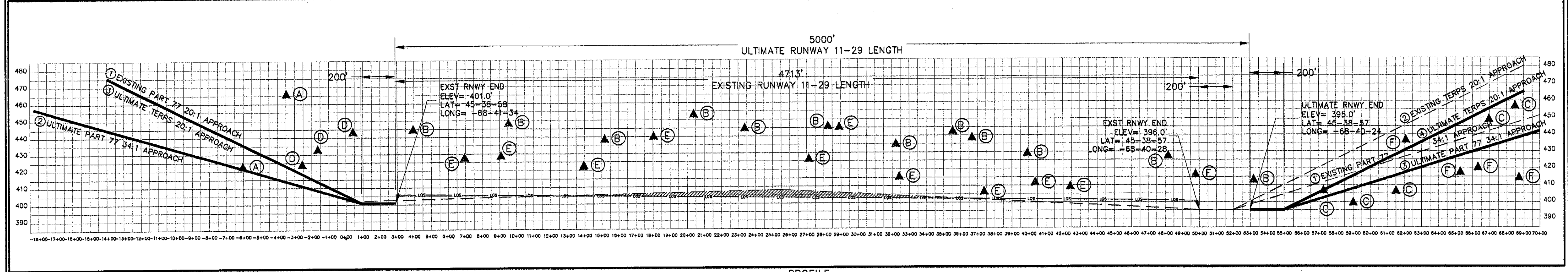
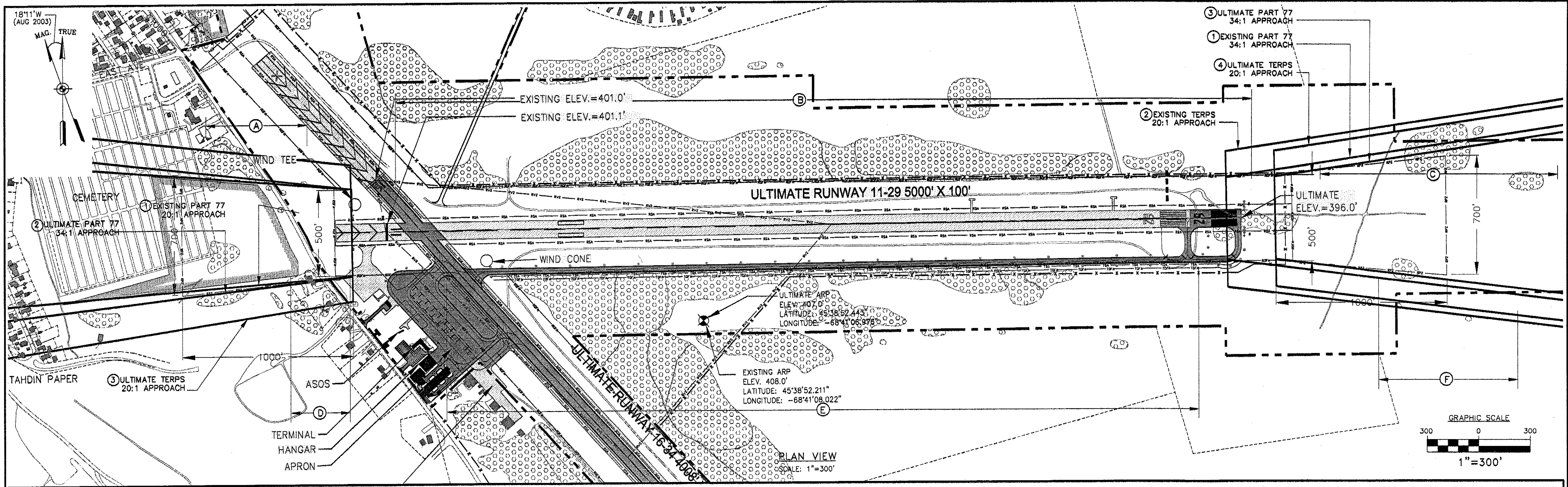

- NOTES:**
1. OBSTRUCTION DATA PROVIDED BY MAINE D.O.T.
 2. TREE SYMBOLS SHOWN IN PROFILE ARE REPRESENTATION OF MULTIPLE OBSTRUCTIONS AND DO NOT REPRESENT INDIVIDUAL OBSTRUCTIONS WITHIN THESE AREAS.
 3. 287' RWY 29 END EXTENSION DOES NOT SOLVE THE RWY LINE-OF-SIGHT PROBLEM. L.O.S. WILL BE ADDRESSED WHEN RWY IS RECONSTRUCTED.

LEGEND	
SYMBOL	DESCRIPTION
	ROAD PAVEMENT EDGE
	EXISTING RUNWAY PAVEMENT EDGE
	PROPOSED RUNWAY PAVEMENT EDGE
	RUNWAY CENTERLINE
	EXISTING PAVEMENT
	ULTIMATE PAVEMENT
	EXISTING TREE LINE
	EXISTING CONTOUR (TYP)
	PROPOSED BUILDINGS
	EXISTING BUILDING
	AIRPORT PROPERTY LINE
	ABUTTING PROPERTY LINES
	EXISTING AVIGATION EASEMENT AREA
	EXISTING/ULTIMATE PENETRATIONS TO BE REMOVED
	SEGMENTED CIRCLE/LIGHTED WINDSOCK
	AIRPORT BEACON/UNLIGHTED WINDSOCK
	EXISTING TURF TIE DOWN
	RUNWAY PROTECTION ZONE
	LINE OF SITE
	RUNWAY SAFETY AREA
	RUNWAY OBJECT FREE AREA
	TAXIWAY SAFETY AREA
	TAXIWAY OBJECT FREE AREA
	RUNWAY VISIBILITY ZONE

TABLE	
SYMBOL	DESCRIPTION
A	VARIOUS PENETRATIONS THROUGH FAR PART 77 7:1 TRANSITION AND 20:1 APPROACH SURFACES. STA. 0+00 TO STA. 6+25, 200' TO 500' LEFT.
B	VARIOUS PENETRATIONS THROUGH FAR PART 77 7:1 TRANSITION SURFACES STA. 6+00 TO STA. 18+00, TO 500' LEFT
C	VARIOUS PENETRATIONS THROUGH FAR PART 77 20:1 APPROACH SURFACES. STA. 21+00 TO STA. 41+50, TO 500' LEFT
D	VARIOUS PENETRATIONS THROUGH FAR PART 77 7:1 TRANSITION SURFACES AND 20:1/34:1 APPROACH SURFACES. STA. 22+50 TO STA. 49+50, TO 500' RIGHT.
E	VARIOUS PENETRATIONS THROUGH FAR PART 77 7:1 TRANSITION SURFACES STA. 8+00 TO STA. 18+00 TO 500' RIGHT.
F	VARIOUS PENETRATIONS THROUGH FAR PART 77 7:1 TRANSITION SURFACES FROM STA. 7+50 TO STA. 4+02 TO 500' RIGHT.

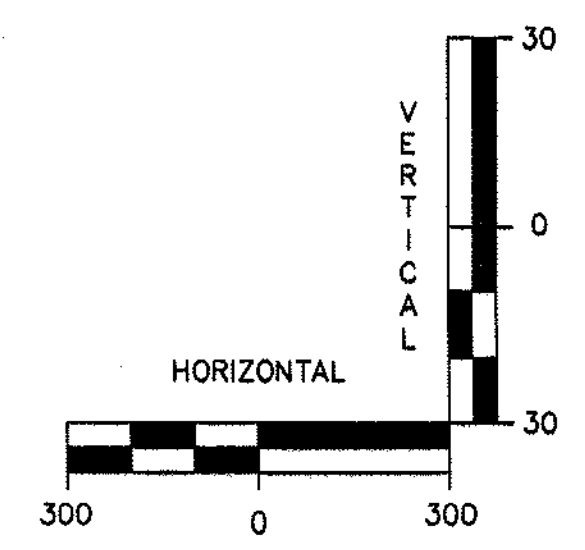

REVISIONS

REV. NO.	DATE	BY	DESCRIPTION

STATE PROJECT NO. SAIP11.1026-02(13)
MILLINOCKET PROJECT NO. AIP3-23-2300-02

HTA
Consulting Engineers

PROJECT DESIGNER
Hoyle, Tanner & Associates, Inc.
150 DOW STREET - MANCHESTER, NH 03101 - 1227
Tel: (603) 669-5555 Fax: (603) 669-4168 WEB PAGE: www.hta-nh.com

DR. BY: RWH
DES. BY: DG
CHKD. BY: JRL
SCALE: AS SHOWN DATE: MARCH, 2004

MILLINOCKET MUNICIPAL AIRPORT
AIRPORT MASTER PLAN UPDATE

RUNWAY 11-29
PLAN AND PROFILE

HTA PROJ. No.: 302902.02
MILLPR11-29.DWG

DRAWING NO. **6**

SHEET 6 OF 9

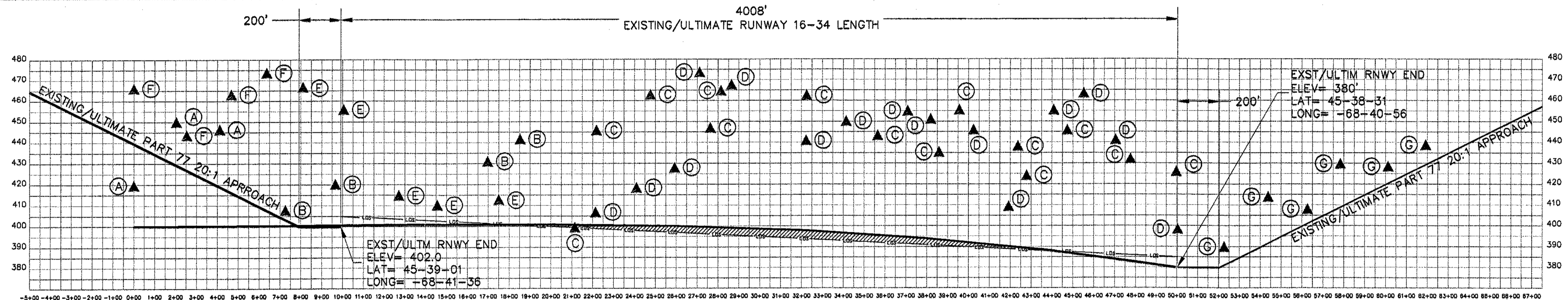
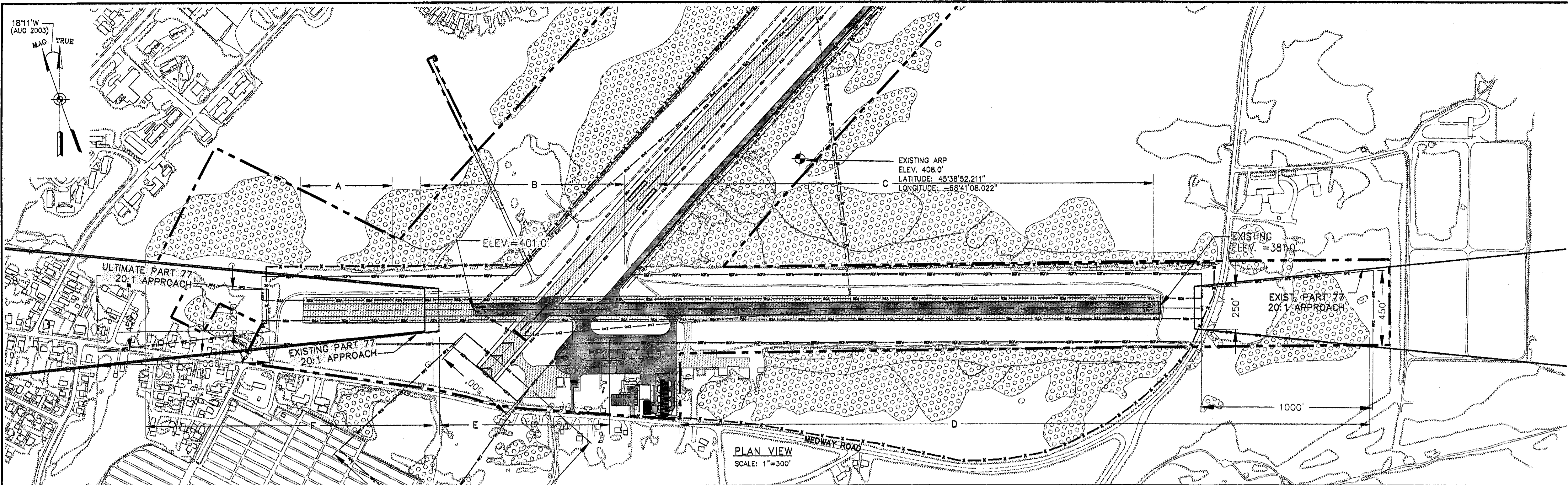

- NOTES:**
1. OBSTRUCTION DATA PROVIDED BY MAINE D.O.T.
 2. TREE SYMBOLS SHOWN IN PROFILE ARE REPRESENTATION OF MULTIPLE OBSTRUCTIONS AND DO NOT REPRESENT INDIVIDUAL OBSTRUCTIONS WITHIN THESE AREAS.
 3. RUNWAY 16-34 LINE-OF-SIGHT (LOS) WILL BE CORRECTED AND APPROACH SURFACES MODIFIED WHEN THE RUNWAY IS RECONSTRUCTED.

LEGEND

SYMBOL	DESCRIPTION	SYMBOL	DESCRIPTION
	ROAD PAVEMENT EDGE		EXISTING PART 77/TERPS PENETRATIONS
	EXISTING PAVEMENT EDGE		SEGMENTED CIRCLE/LIGHTED WINDSOCK
	PROPOSED PAVEMENT EDGE		AIRPORT BEACON/UNLIGHTED WINDSOCK
	RUNWAY CENTERLINE		EXISTING TURF TIE DOWN
	EXISTING PAVEMENT		RUNWAY PROTECTION ZONE
	ULTIMATE PAVEMENT		LINE OF SITE
	EXISTING TREE LINE		RUNWAY SAFETY AREA
	EXISTING CONTOUR (TYP)		RUNWAY OBJECT FREE AREA
	PROPOSED BUILDINGS		TAXIWAY SAFETY AREA
	EXISTING BUILDING		TAXIWAY OBJECT FREE AREA
	AIRPORT PROPERTY LINE		RUNWAY VISIBILITY ZONE
	ABUTTING PROPERTY LINES		
	EXISTING AVIGATION EASEMENT AREA		

TABLE

A	VARIOUS PENETRATIONS THROUGH FAR PART 77 7:1 TRANSITION AND 20:1 APPROACH SURFACES. STA. 0+00 TO STA. 5+25, 200' TO 500' LEFT.
B	VARIOUS PENETRATIONS THROUGH FAR PART 77 7:1 TRANSITION SURFACES STA. 6+00 TO STA. 19+00, TO 500' LEFT
C	VARIOUS PENETRATIONS THROUGH FAR PART 77 20:1 APPROACH SURFACES. STA. 21+00 TO STA. 41+50, TO 500' LEFT
D	VARIOUS PENETRATIONS THROUGH FAR PART 77 7:1 TRANSITION SURFACES AND 20:1/34:1 APPROACH SURFACES. STA. 22+50 TO STA. 49+50, TO 500' RIGHT.
E	VARIOUS PENETRATIONS THROUGH FAR PART 77 7:1 TRANSITION SURFACES STA. 8+00 TO STA. 18+00 TO 500' RIGHT.
F	VARIOUS PENETRATIONS THROUGH FAR PART 77 7:1 TRANSITION SURFACES FROM STA. 7+50 TO STA. -4+02 TO 500' RIGHT.
G	VARIOUS PENETRATIONS THROUGH FAR PART 77 7:1 TRANSITION AND 20:1 APPROACH SURFACES. STA. 50+75 TO STA. 52+25, 400' RIGHT TO 500' LEFT.

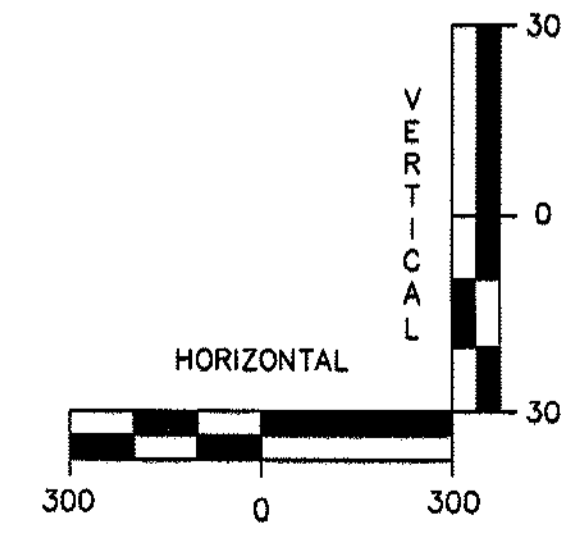

REV. NO.	DATE	BY	DESCRIPTION

STATE PROJECT NO. SAIP11-1026-02(13)
MILLINOCKET PROJECT NO. AIP3-23-2300-02

HTA
Consulting Engineers

PROJECT DESIGNER
Hoyle, Tanner & Associates, Inc.
150 DOW STREET - MANCHESTER, NH 03101-1227
Tel: (603) 669-5555 Fax: (603) 669-4168 WEB PAGE: www.hta-nh.com

DES. BY: DG
DR. BY: DDS
CHKD. BY: JRL

SCALE: AS SHOWN DATE: MARCH, 2004

MILLINOCKET MUNICIPAL AIRPORT
AIRPORT MASTER PLAN UPDATE

**RUNWAY 16-34
PLAN AND PROFILE**

HTA PROJ. No.: 302902.02
MILLPR16-34.DWG

DRAWING NO.
7

SHEET 7 OF 9

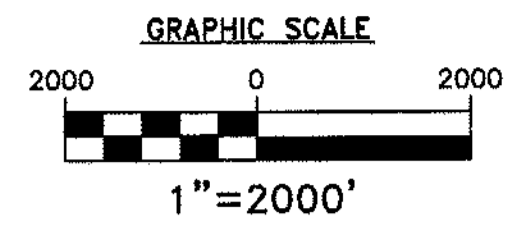
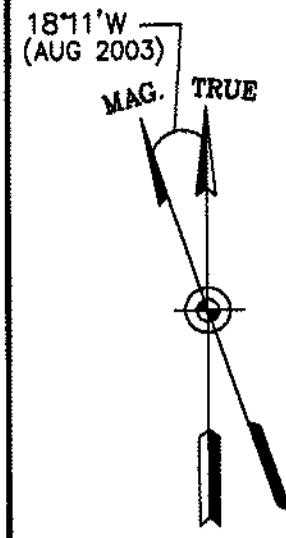

LEGEND			
SYMBOL	DESCRIPTION	SYMBOL	DESCRIPTION
	EXISTING ROADS		FAR PART 77 APPROACH SURFACE ABOVE HORIZONTAL SURFACE ELEVATION
	CONICAL SURFACE		TERPS APPROACH SURFACE
	HORIZONTAL SURFACE		PRIMARY SURFACE
	SURFACE ELEVATION CONTOUR		
	EXISTING HAZARD EAGLES' NEST ENDANGERED SPECIE		

Table 3-6: Part 77 Airspace Surfaces - Millinocket Regional Airport (Ultimate)

Airport Data	Runway 11	Runway 29	Runway 16	Runway 34
Classification	'B' RW Larger Than Utility	'B' RW Larger Than Utility	'A' Utility	'A' Utility
Approach	Visual	Non-precision	Visual	Visual
Visibility Minimums	3-mile	1-mile	3-mile	3-mile
Airport Elevation	408'			
Airport Imaginary Surface				
Horizontal Surface:				
Horizontal Surface Elevation	558'			
Horizontal Surface Radius	10,000	10,000	5,000	5,000
Conical Surface:				
Horizontal Distance	4,000	4,000	4,000	4,000
Slope	20:1	20:1	20:1	20:1
Primary Surface:				
Length beyond runway end	200	200	200	200
Width	500	500	250	250
Approach Surface:				
Horizontal Distance	10,000	10,000	5,000	5,000
Inner Edge Width	500	250	250	250
Outer Edge Width	3,500	3,500	1,250	1,250
Slope	34:1	34:1	20:1	20:1
Transitional Surfaces:	7:1	7:1	7:1	7:1

1. Dimensions are in feet unless otherwise noted.

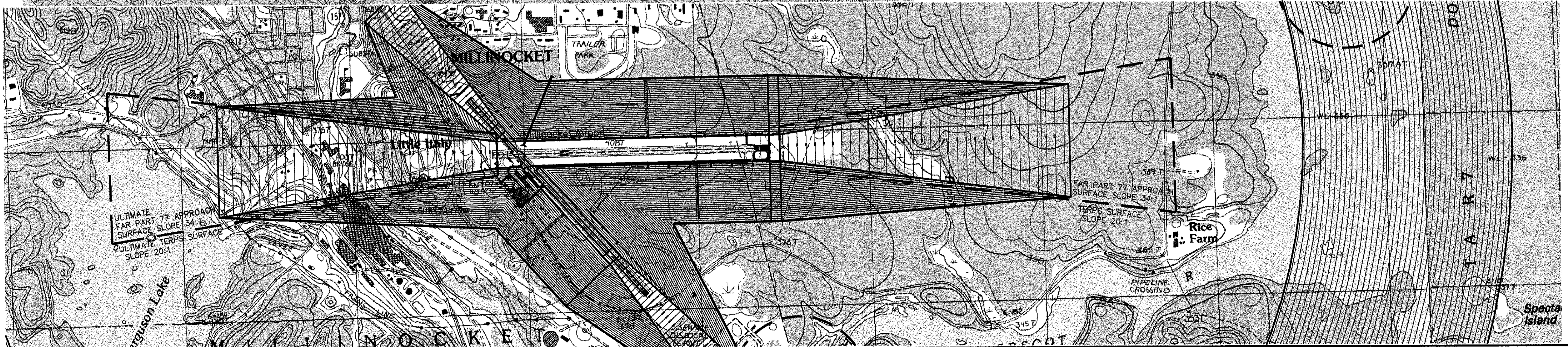
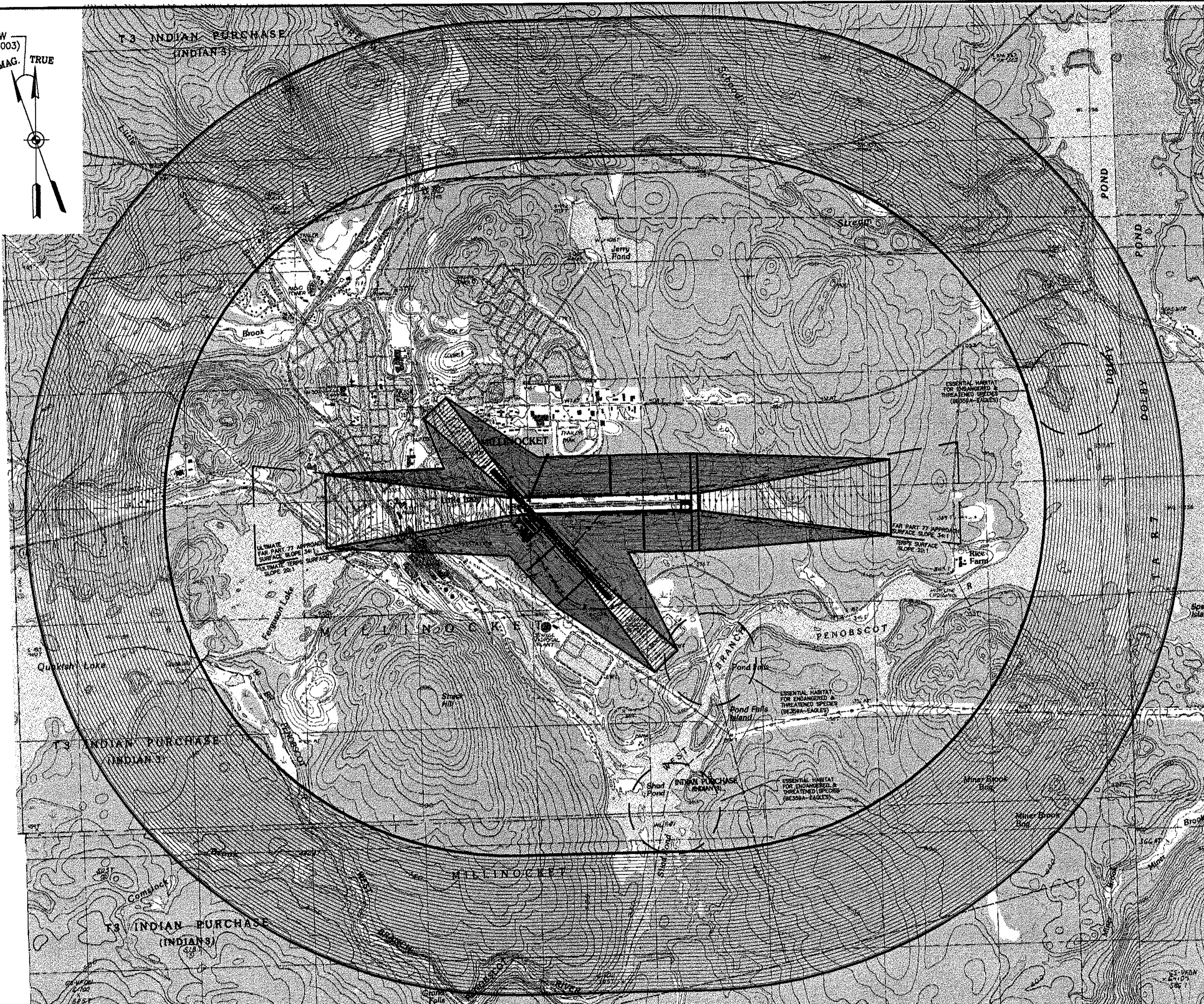
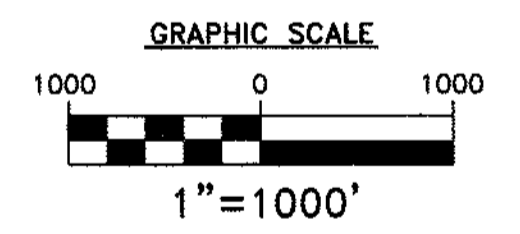

STATE PROJECT NO. SA111.1028-02(13)
 PROJECT NO. MILLINOCKET PROJECT NO. AIP3-23-2300-02

PROJECT DESIGNER: **Hoyle, Tanner & Associates, Inc.**
 150 DOW STREET - MANCHESTER, NH 03101 - 1227
 Tel: (603) 669-5555 Fax: (603) 669-4188 WEB PAGE: www.hta-nh.com

DESIGNED BY: DC
 DRAWN BY: RWH
 CHECKED BY: JRL

DATE: MARCH, 2004
 SCALE: AS SHOWN

MILLINOCKET MUNICIPAL AIRPORT AIRPORT MASTER PLAN UPDATE
AIRPORT LAYOUT PLAN FAR PART 77

HTA PROJ. No.: 302902.02
 MLP77.DWG

DRAWING NO. **8**

SHEET 8 OF 9

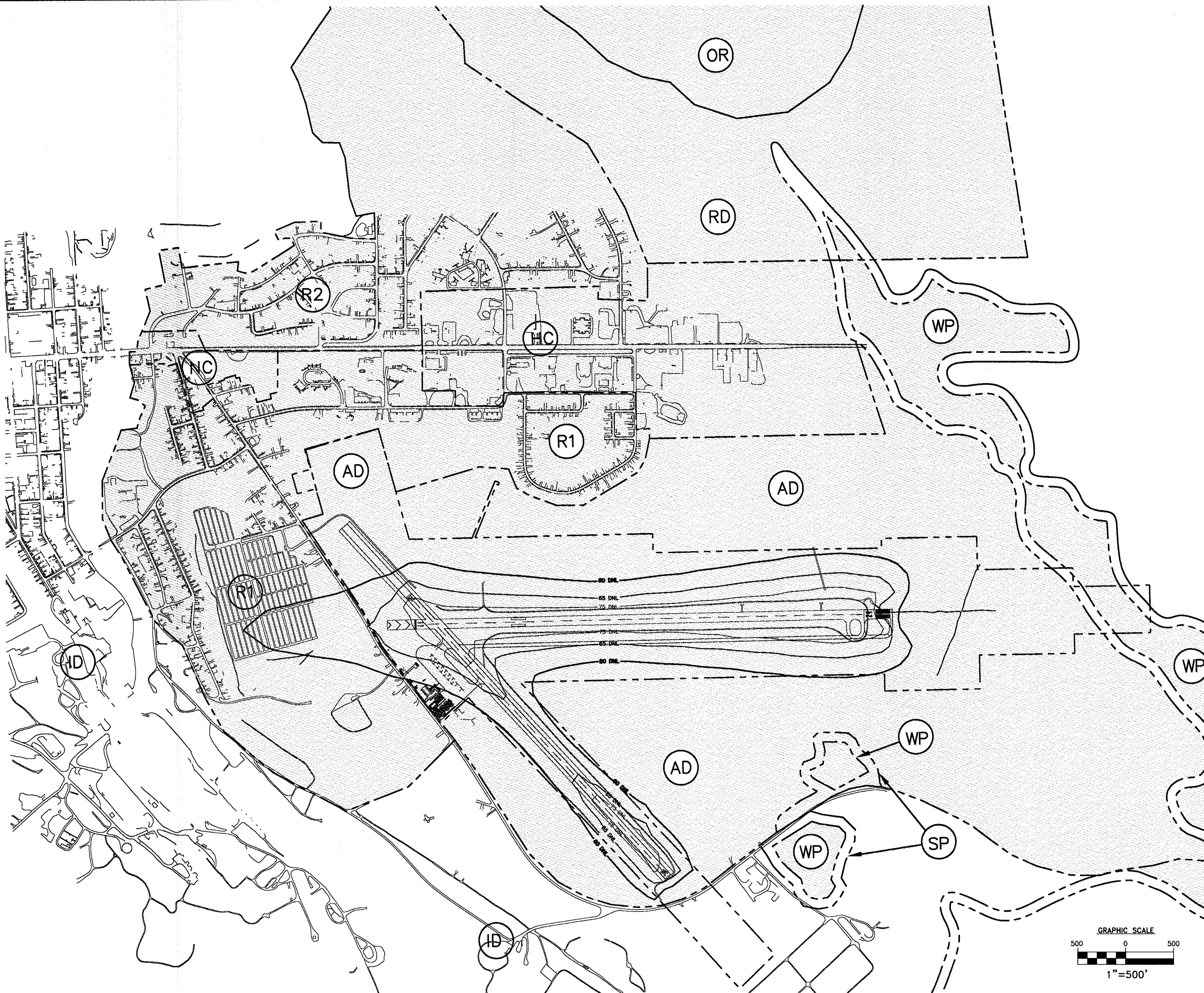
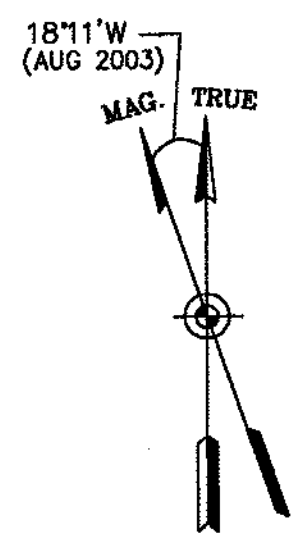

LEGEND	
SYMBOL	DESCRIPTION
	AIRPORT PROPERTY LINE
	RUNWAY CENTERLINE
	NOISE CONTOUR
	ABUTTING PROPERTY LINES
ZONES	
	DOWNTOWN RESIDENTIAL DEVELOPMENT
	MEDIUM DENSITY RESIDENTIAL DEVELOPMENT
	RURAL DEVELOPMENT
	NEIGHBORHOOD COMMERCIAL DEVELOPMENT
	HIGHWAY COMMERCIAL DEVELOPMENT
	INDUSTRIAL DEVELOPMENT
	OPEN SPACE RECREATION DEVELOPMENT
	WETLAND PROTECTION
	SHORELAND PROTECTION
	AIRPORT DEVELOPMENT
	COMMERCIAL FORESTRY

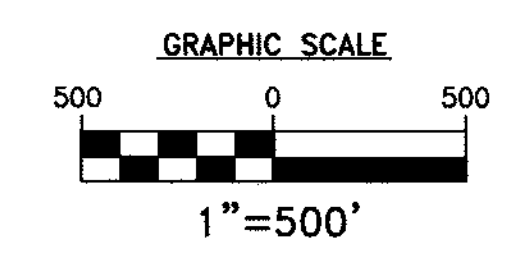

PROJECT DESIGNER Hoyle, Tanner & Associates, Inc. 150 DOW STREET - MANCHESTER, NH 03101 - 1227 Tel: (603) 669-5555 Fax: (603) 669-4188 WEB PAGE: www.hta-nh.com		STATE PROJECT NO. SA1P11-1026-02(13) MILLINOCKET PROJECT NO. AIP3-23-2300-02									
DES. BY DG DR. BY RWH CHKD. BY JRL		REVISIONS <table border="1"> <tr> <th>REV. NO.</th> <th>DATE</th> <th>BY</th> <th>DESCRIPTION</th> </tr> <tr> <td>1</td> <td></td> <td></td> <td></td> </tr> </table>		REV. NO.	DATE	BY	DESCRIPTION	1			
REV. NO.	DATE	BY	DESCRIPTION								
1											
MILLINOCKET MUNICIPAL AIRPORT AIRPORT MASTER PLAN UPDATE LAND USE AND NOISE CONTOUR PLAN		DRAWING NO. 9									
HTA PROJ. No.: 302902.02 MILDUSE09.DWG		SHEET 9 OF 9									